

Apple Health Records

Quick Start Guide for iOS



Contents

- Introduction
- Ensure that your iOS Software is Updated
- Set up your Health Profile on your iPhone
- Add your Health Records from Women's College Hospital
- View your Health Records from Women's College Hospital
- Protecting the Privacy of your Personal Health Information

Introduction

Apple Health Records enables patients to download, manage, combine and utilize their own health data from multiple participating organizations directly from their iPhone. Accessed from your existing Health app, Health Records directly connects your device to your WCH myHealthRecord account allowing you to see all your medical data in one view.

You will need to set up your Health Profile to use this new feature. The instructions below will guide you through the required steps. Should you require support, please contact: myhealthrecord@wchospital.ca, 416-323-6205

Ensure that your iOS Software is Updated

Before you begin, please ensure that the iOS software on your iPhone has been updated to the most recent version.

Instructions: <https://support.apple.com/en-ca/HT204204>

Adding Electronic Health Records in the Health app requires an iPhone with iOS version 11.3 or later.

Set up your Health Profile on your iPhone

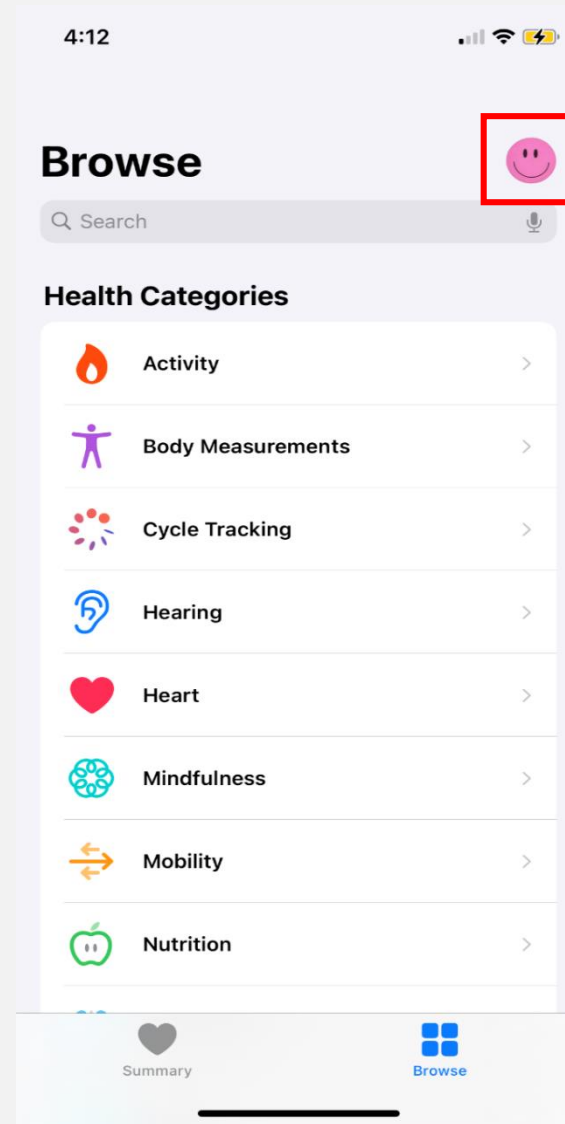
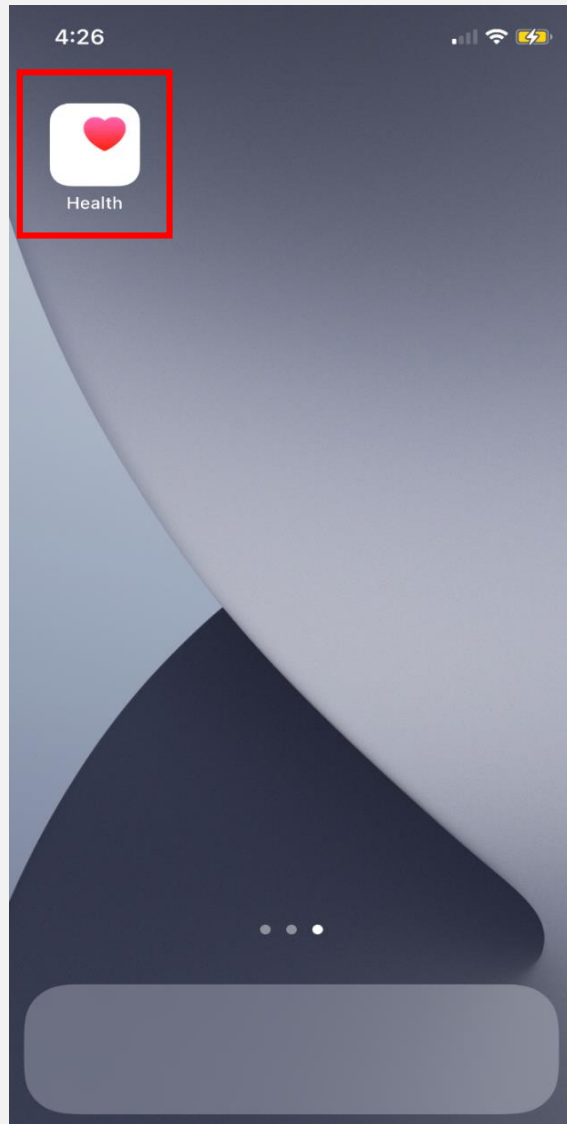

Open the **Health app** on your iPhone.

Tap your **Profile Picture** in the top-right corner.

Set up your Health Profile on your iPhone

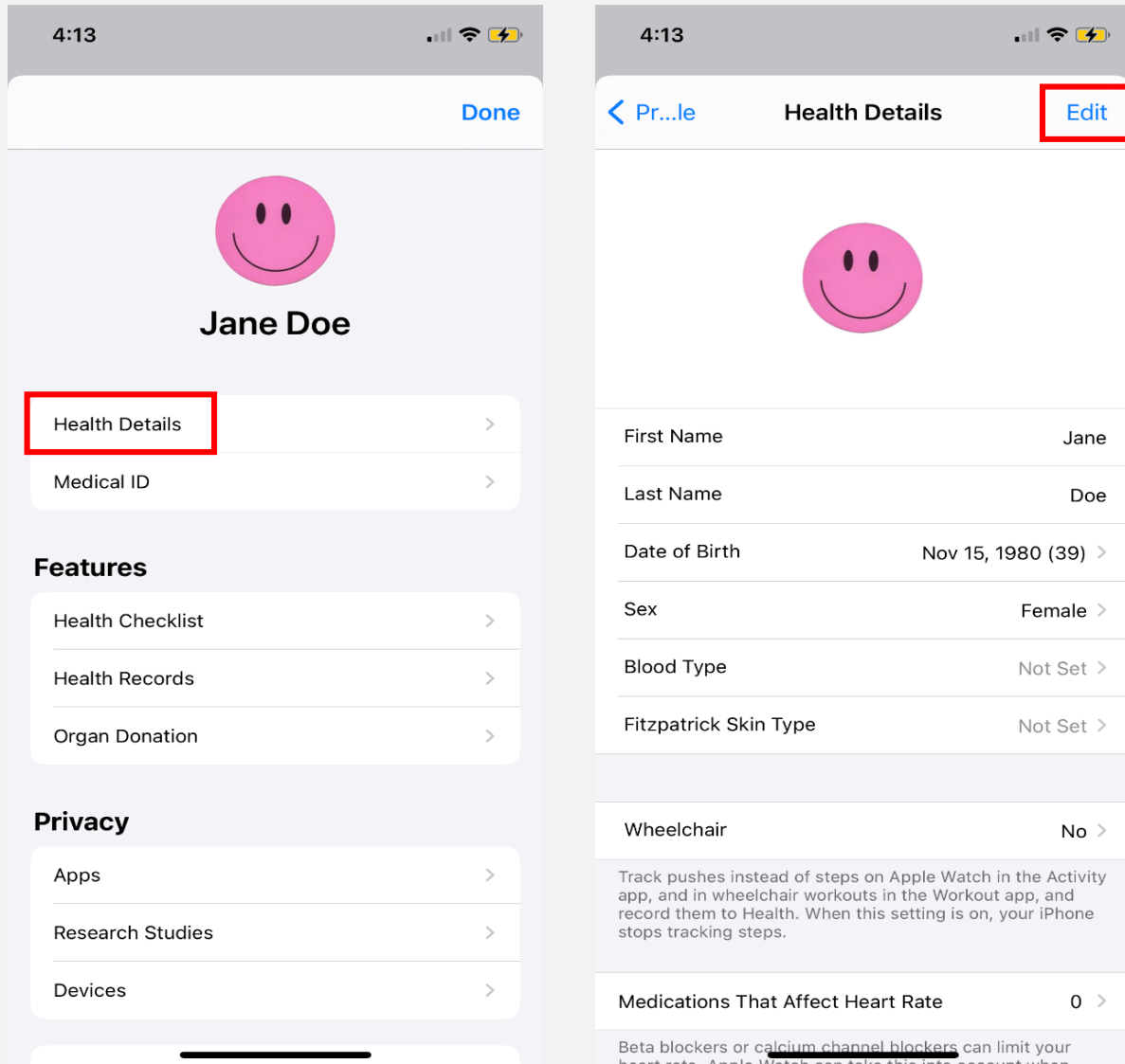

Tap **Health Details** and then tap **Edit** in the top-right corner.

Fill in your information as indicated on the screen.

Tap **Done** in the top-right corner once you are finished.

Add your Health Records from Women's College Hospital

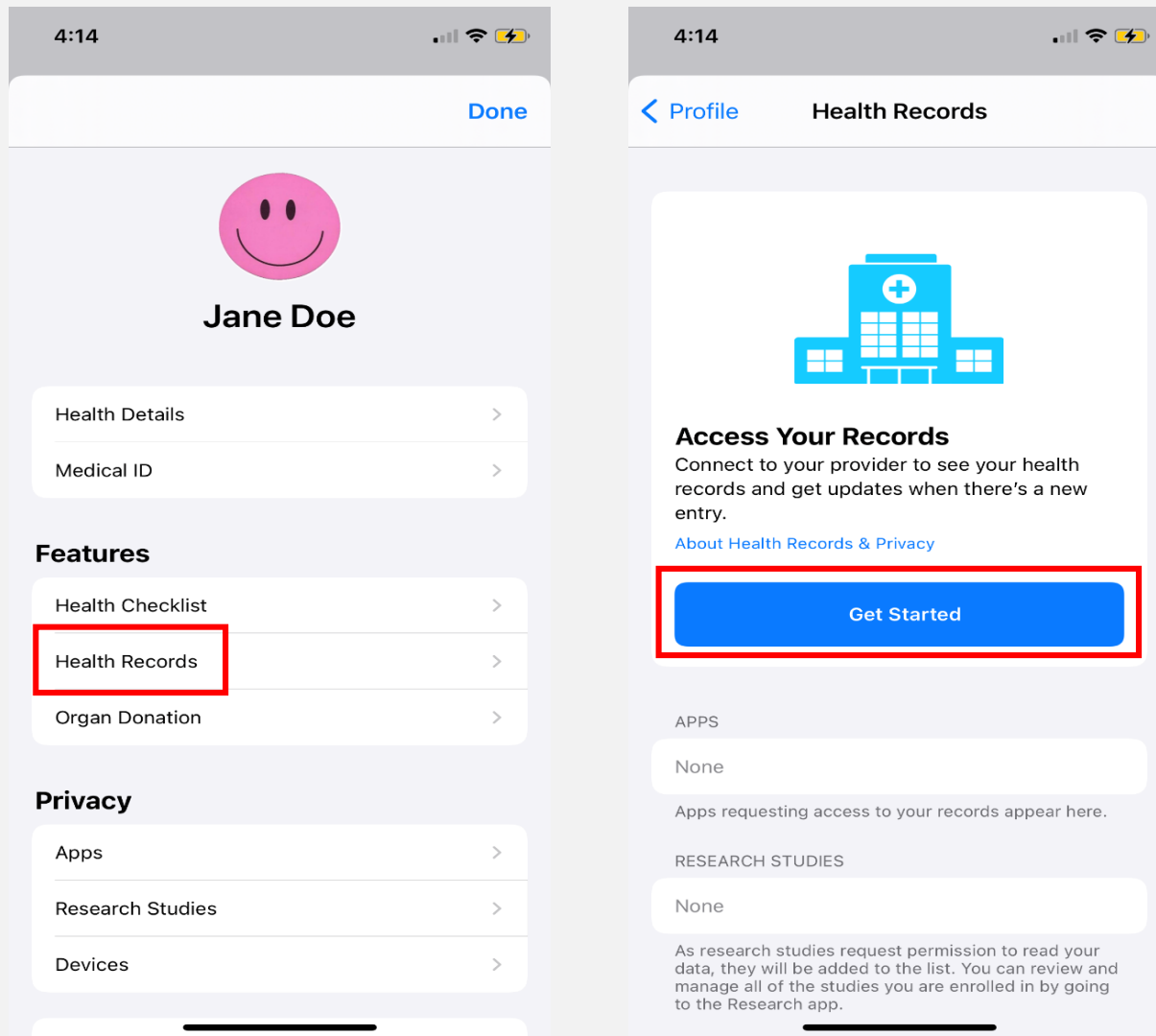

Under **Features**, tap **Health Records** and then tap **Get Started**.

Add your Health Records from Women's College Hospital

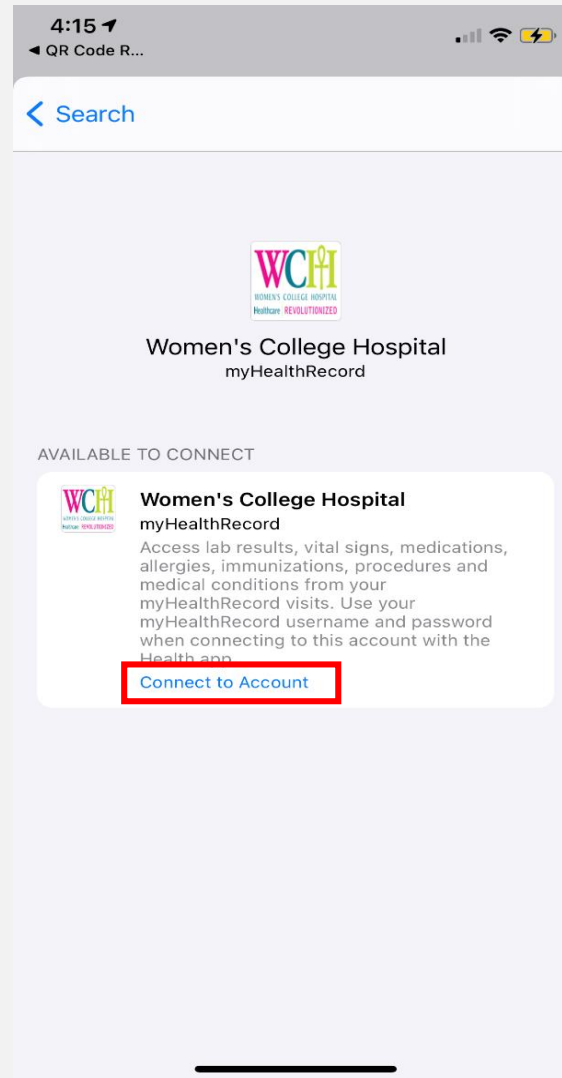
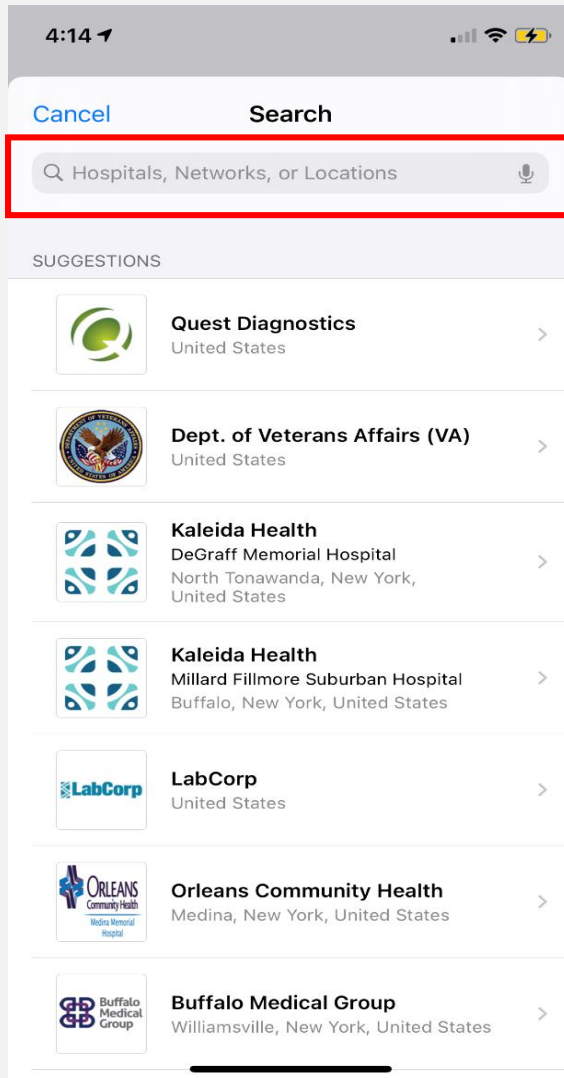

Enter **Women's College Hospital** in the search bar and tap it once it appears

Under **Available To Connect**, select **Women's College Hospital myHealthRecord** and then tap **Connect to Account**.

Add your Health Records from Women's College Hospital



4:16
QR Code R...

Cancel wchchart.ca AA ↻

Afficher en français

MY Health
RECORD
WCH WOMEN'S COLLEGE HOSPITAL

myHealthRecord Username

Password

SIGN IN

[Forgot Username?](#) [Forgot Password?](#)

[No Activation Code?](#)

SELF-SIGN UP NOW

MyChart® licensed from Epic Systems Corporation, © 1999 - 2020.

A new page will open. Enter your myHealthRecord username and password, then click **SIGN IN**. You might be asked to save your password.

If you don't have a myHealthRecord account, please sign-up for an account by clicking on the following link:
<https://www.wchchart.ca/Mychart/Authentication/Login?>

Add your Health Records from Women's College Hospital



Once you have signed in, you will be asked to review information about Apple Health and the Women's College Hospital (WCH) Terms of Use that will help you decide whether or not you would like to allow or deny Apple Health from connecting to your health records.

It is important that you read the **WCH TERMS OF USE AGREEMENT** before deciding to connect with Apple Health. If you do not agree to the WCH Terms of Use, then do not authorize the disclosure of your personal health information (PHI) from the WCH patient portal to Apple Health Records.

Add your Health Records from Women's College Hospital

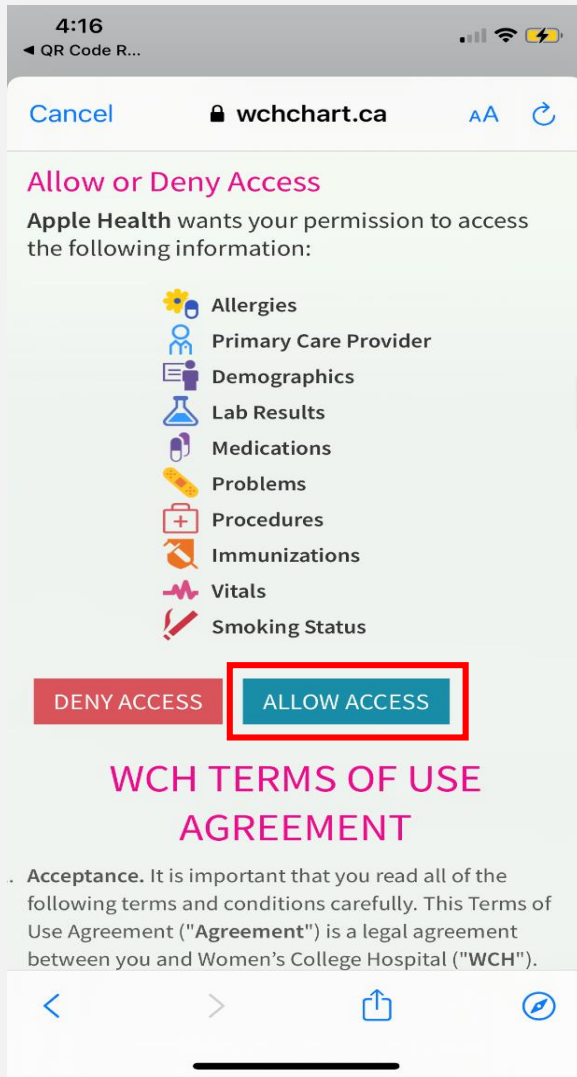

If you would like to allow access after reading the WCH Terms of Use, scroll up and tap **Allow Access**. If you do not wish to allow access, tap **Deny Access**. These buttons are found around the middle of the page.

Add your Health Records from Women's College Hospital

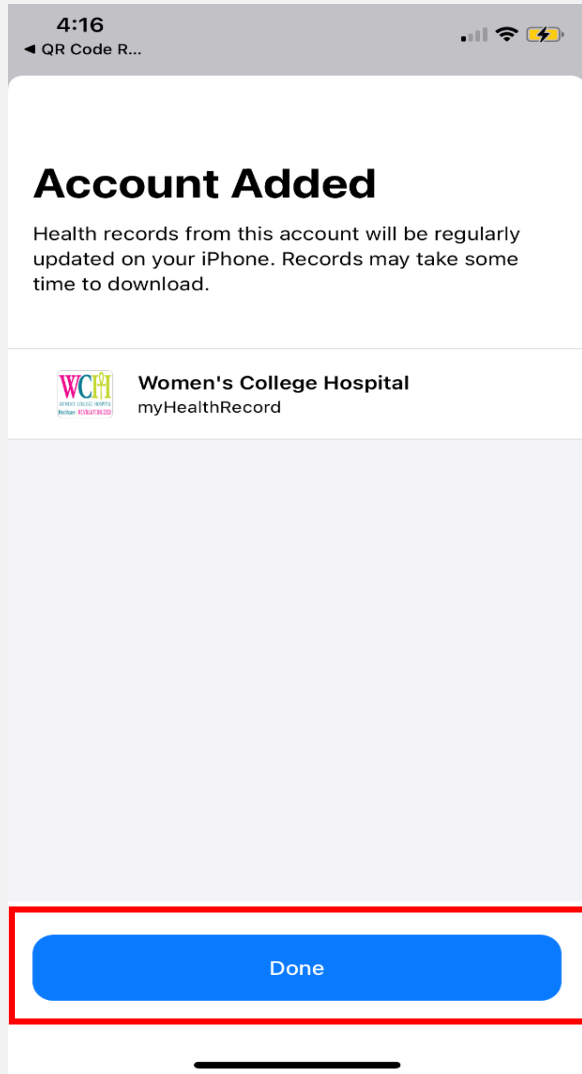

If you selected **Allow Access**, you will receive an account added confirmation. Click **Done** to continue.

Add your Health Records from Women's College Hospital

Note that you may be asked to **Help Improve Health Records** by sharing analytics data. Deciding to release your PHI to a third party is a significant decision which you should consider carefully before authorizing. You should clearly understand how Apple will use and protect your PHI before authorizing the disclosure. WCH recommends against disclosing your PHI to a third party for any reason other than providing an authorized service to you. As such, WCH recommends that you opt out of “Share Data With Analytics” through Apple Health.

WCH does not assume any responsibility for the disclosure of your PHI to third parties that you authorize.

Add your Health Records from Women's College Hospital

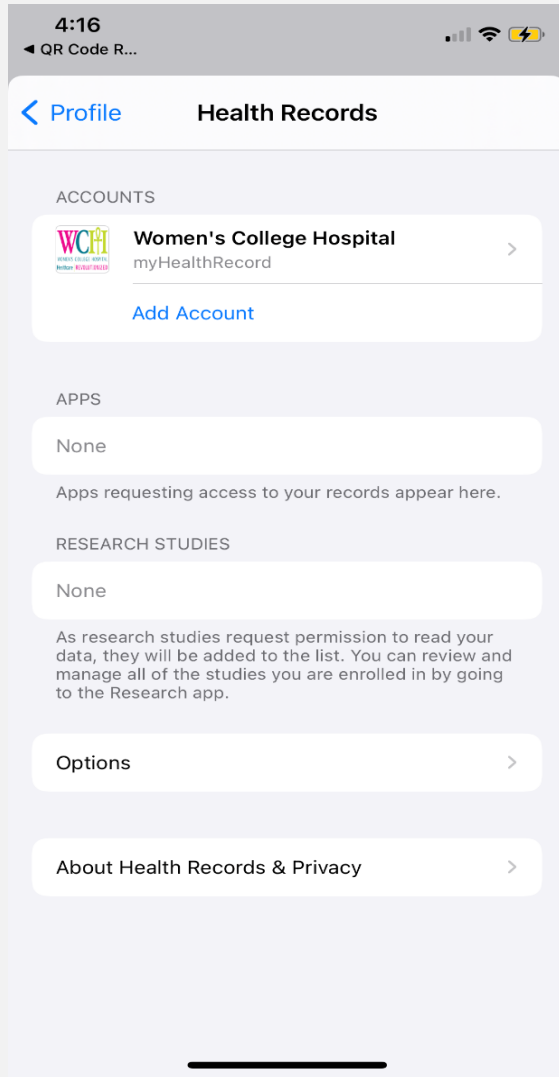

It may take a few minutes for your records to update and your information to appear.

You can repeat these steps for each supported health institution that you wish to connect to your app.

After you add a new health institution, the Health app automatically updates your health records periodically. If there's an issue with your health records, please contact your provider.

Add your Health Records from Women's College Hospital

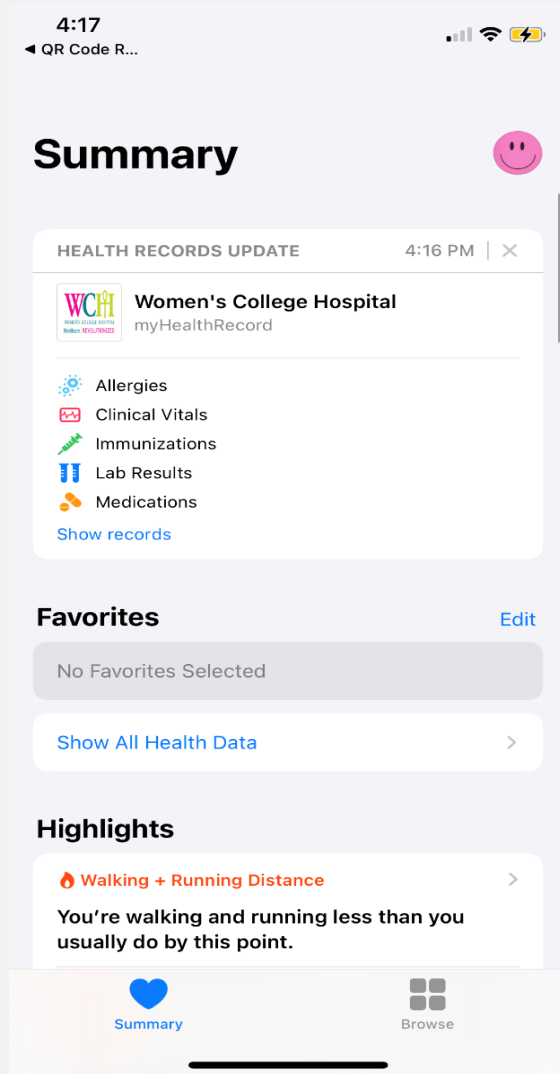

Back on the **Summary** page, you will receive periodic notifications when your health records are updated.

View your Health Records from Women's College Hospital

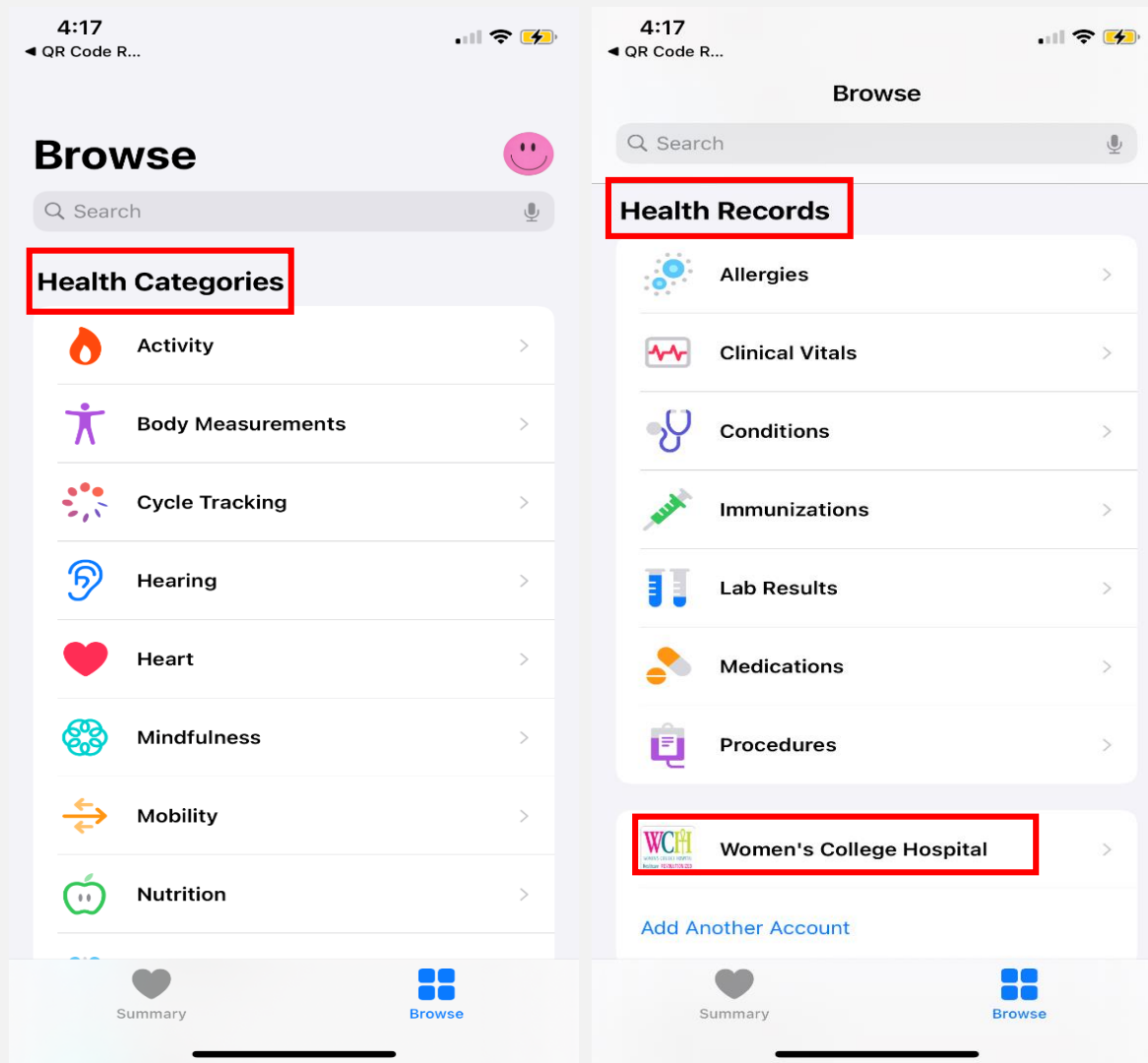

At the top of the **Browse** tab, you will have **Health Categories**. Scrolling down brings you to your **Health Records**.

If you would like to see results specifically from Women's College Hospital, tap **Women's College Hospital** underneath **Health Records**.

View your Health Records from Women's College Hospital

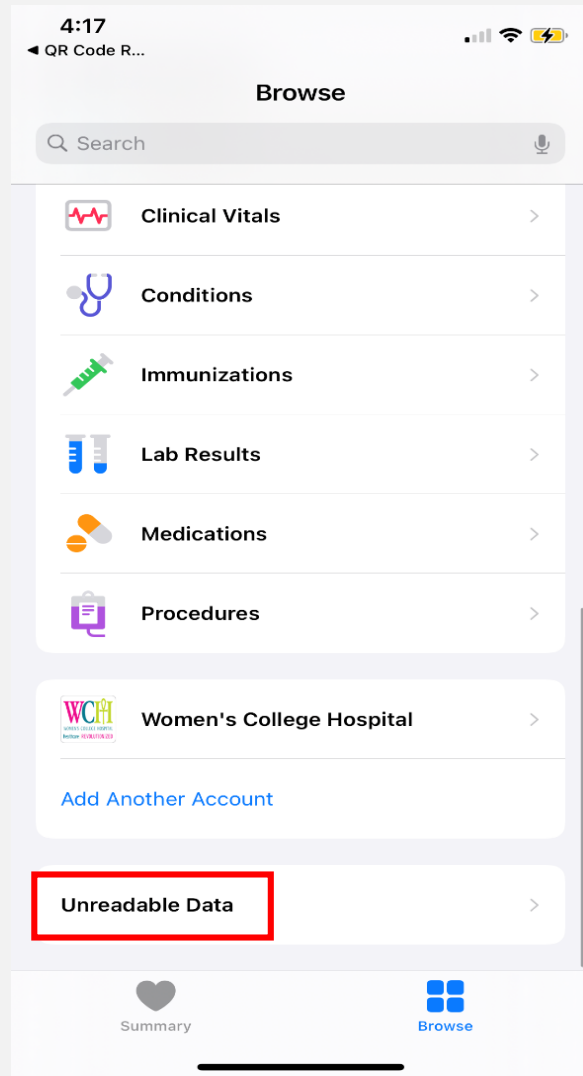

Health Records will display information from any institution you have connected to, including Women's College Hospital.

Certain elements of your health record are not currently readable by the Health app, including imaging results. This data will be found in the category at the bottom of the **Browse** page under **Unreadable Data**.

Protecting the Privacy of your Personal Health Information

WCH knows that your personal health information is important to you and must be protected. Personal health information is any information that can identify you and link you to healthcare services you receive. WCH takes steps to protect your personal health information from theft, loss and unauthorized access, copying, modification, use, disclosure and disposal. These steps include:

- Privacy and security-trained staff
- Encryption technologies
- Locked offices, drawers and filing cabinets
- Firewalls
- User IDs and passwords

For more information on how we handle your information and your privacy choices or to raise a concern, contact our Privacy Office:

Privacy Office – 76 Grenville Street, Toronto, Ontario, M5S 1B2

Phone: 416-323-7702 **Email:** privacy@wchospital.ca

www.womenscollegehospital.ca/privacy

Protecting the Privacy of your Personal Health Information

Note that unauthorized modification of your iPhone (also known as “jailbreaking”) can compromise security features and result in numerous issues to the hacked iPhone, including:

Security vulnerabilities: Jailbreaking your iPhone eliminates security measures designed to protect your personal information and your iPhone. Hackers may steal your personal information, damage your device, attack your network, or introduce malware, spyware, or viruses.

Instability: Frequent and unexpected crashes of your iPhone, built-in apps and third-party apps, and loss of data.

Disclaimer: WCH will not be liable for any unauthorized modifications that have been made to your iPhone that may result in security vulnerabilities and/or device instability.